

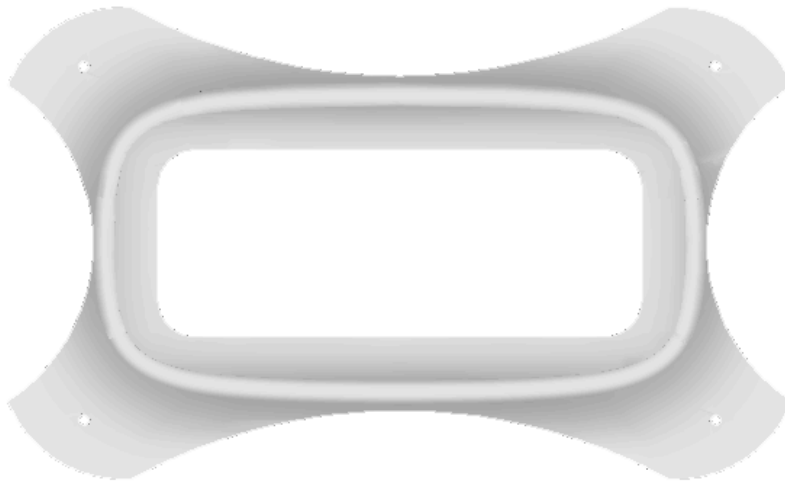

CORE™ ABOVE CEILING MOUNTING KIT

For use with CORE™ MIMO DAS Antennas

VGMIMO152031MT



DESCRIPTION

Use the Above Ceiling Mounting Kit where the antenna should be kept from public view.

Use the plastic holder to support the antenna.

Use the Mounting Kit by attaching it to the plenum side of the ceiling tile.

Double-sided adhesive tape (provided) can be used to attach the mount to the ceiling tile.

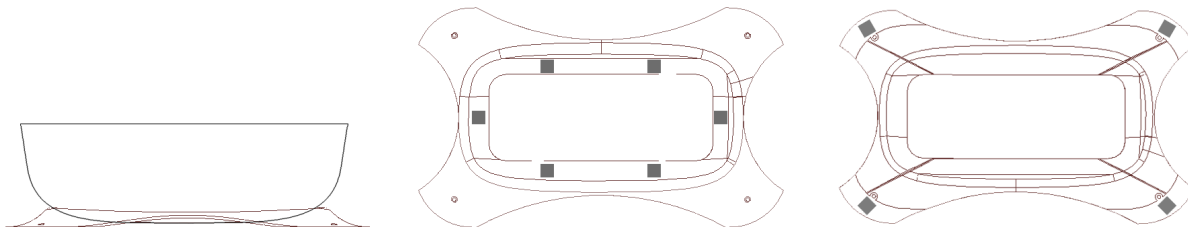

Side View

Top View

Bottom View



CORE™ ABOVE CEILING MOUNTING KIT

For use with CORE™ MIMO DAS Antennas

VGMIMO152031MT



Mounting Kit and Antenna are sold separately.
The Core™ MIMO and Above Ceiling Mounting Kit are ordered and shipped separately.

INSTALLATION

ATTACHING THE ANTENNA TO THE ABOVE CEILING MOUNTING KIT

1. Using alcohol, clean the top of the antenna radome.
2. Peel off the protective film from six of the double-sided tape squares provided, place these inside the center of the plastic antenna holder.
3. Next, peel off the protective film from six of the double sided tape squares that have been placed inside the holder.
4. Insert the antenna radome into the plastic support and press together firmly.

ATTACHING THE CEILING MOUNT TO THE CEILING

5. Clean the area on the ceiling tile where the antenna will be mounted.
6. Remove the protective film from the remaining four of the double-sided tape squares provided, place one square on bottom of each support leg and press firmly onto the ceiling.

NOTE: The varying ceiling materials may require the use of various screws or anchors (not included) to secure the Mounting Kit to the ceiling.